

**KEY PLAN**

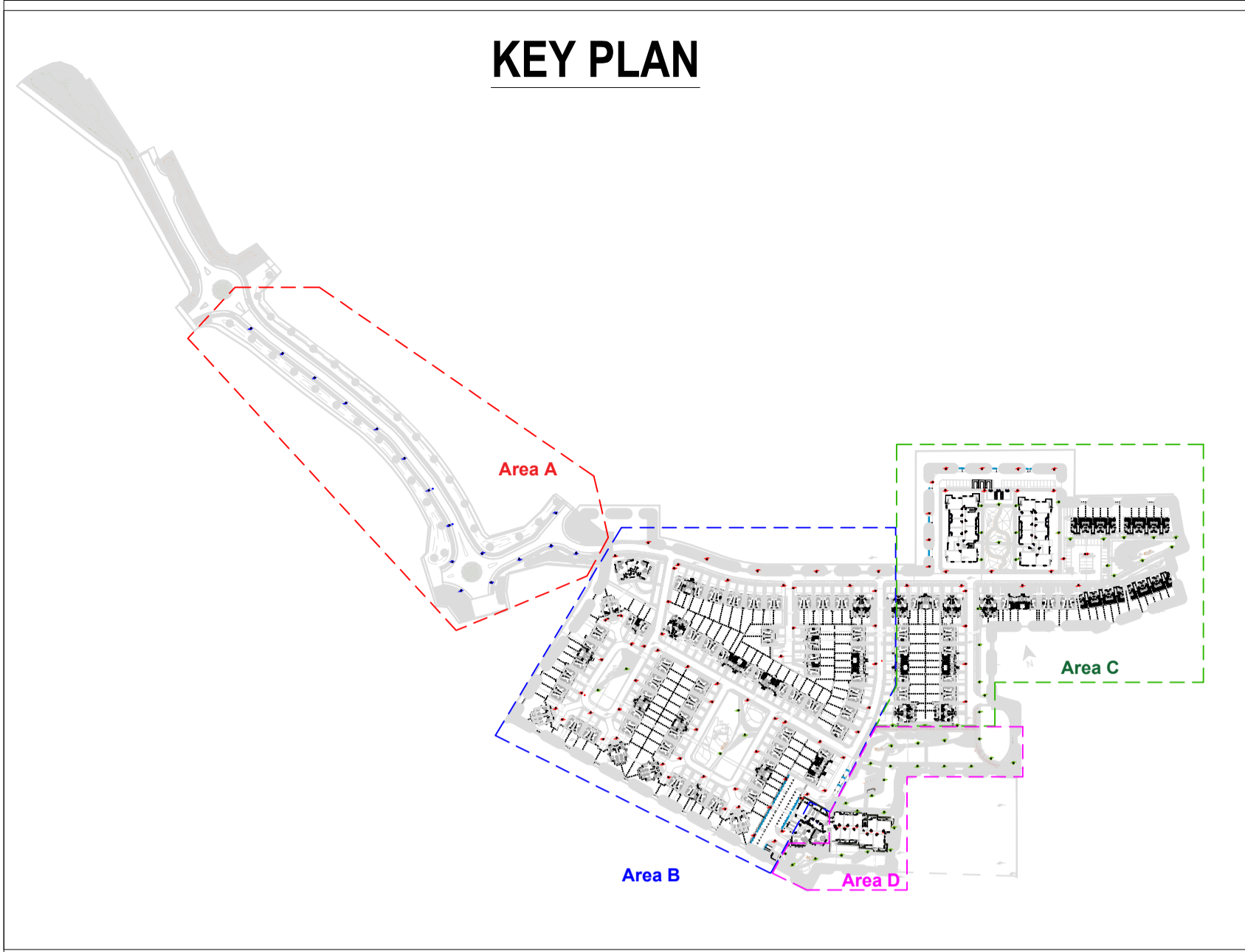

**DIALux**

**Isolines**

- 1.0 lx
- 2.0 lx
- 3.0 lx
- 5.0 lx
- 10.0 lx
- 20.0 lx
- 30.0 lx

**SAFETY, HEALTH & ENVIRONMENTAL INFORMATION**

IN ADDITION TO THE HAZARDS / RISKS NORMALLY ASSOCIATED WITH THE TYPES OF WORK DETAILED ON THIS DRAWING, NOTE THE FOLLOWING:

**SIGNIFICANT RESIDUAL RISKS:**

- SERVICES AT HIGH LEVEL (WITHIN CEILINGS, VOIDS ETC.) - INJURY DUE TO RISK OF FALLING
- WORKING IN CONFINED SPACES - CLAUSTROPHOBIA, INJURY DUE TO SPACE RESTRICTIONS.

**ACTION TO BE TAKEN:**

- INSTALLER TO ABIDE BY THE "WORKING AT HEIGHT REGULATIONS" AND USE OF THE CORRECT LIFTING PLANT, SUPPORT EQUIPMENT AND PPE.
- USE OF THE CORRECT PPE AND PREFERABLY WORK WITH ANOTHER COLLEAGUE AT ALL TIMES.

**DISCREPANCIES:**  
ANY DISCREPANCY IS TO BE REFERRED TO CONSULTANT BEFORE PROCEEDING.

**DISCREPANCIES:**  
THIS DRAWING IS ISSUED ON THE CONDITION THAT IT IS NOT COPIED OR DISCLOSED TO ANY OTHER UNAUTHORISED PERSON WITHOUT THE PRIOR CONSENT OF "WOODSPS".

**RELATED DOCUMENTS:**  
THIS DRAWING SHALL BE READ IN CONJUNCTION WITH THE WRITTEN SPECIFICATION WHERE APPROPRIATE

**LEGEND**

	<p><b>FITTING TYPE</b> Type A  <b>MANUFACTURE</b> Micro Plus Germany  <b>PRODUCT</b> MP6 2W 15W  <b>MOUNTING</b> 6m OCTAGONAL COLUMN  <b>LUMINOUS</b> Flux  <b>IP RATING</b> IP 67  <b>CLOUR</b> GRAYITE  <b>DIMENSIONS</b> LENGTH: 540mm                  WIDTH: 255mm                  HEIGHT: 100mm                  No. in Project: 85</p>
	<p><b>FITTING TYPE</b> Type B  <b>MANUFACTURE</b> Micro Plus Germany  <b>PRODUCT</b> MP6 1W 15W  <b>MOUNTING</b> 6m OCTAGONAL COLUMN  <b>LUMINOUS</b> Flux  <b>IP RATING</b> IP 67  <b>CLOUR</b> GRAYITE  <b>DIMENSIONS</b> LENGTH: 540mm                  WIDTH: 255mm                  HEIGHT: 100mm                  No. in Project: 86</p>
	<p><b>FITTING TYPE</b> Type C  <b>MANUFACTURE</b> Micro Plus Germany  <b>PRODUCT</b> MP6 1W 40W  <b>MOUNTING</b> 6m OCTAGONAL COLUMN  <b>LUMINOUS</b> Flux  <b>IP RATING</b> IP 67  <b>CLOUR</b> GRAYITE  <b>DIMENSIONS</b> LENGTH: 540mm                  WIDTH: 255mm                  HEIGHT: 100mm                  No. in Project: 16</p>
	<p><b>FITTING TYPE</b> Photocell  <b>MANUFACTURE</b> Chauvet Industries  <b>PRODUCT</b> Long Life Photocell  <b>MOUNTING</b> Nema Socket  <b>LUMINOUS</b> N/A  <b>IP RATING</b> IP 67  <b>CLOUR</b> BLACK  <b>DIMENSIONS</b> LENGTH: N/A                  WIDTH: N/A                  HEIGHT: N/A                  No. in Project: 157</p>

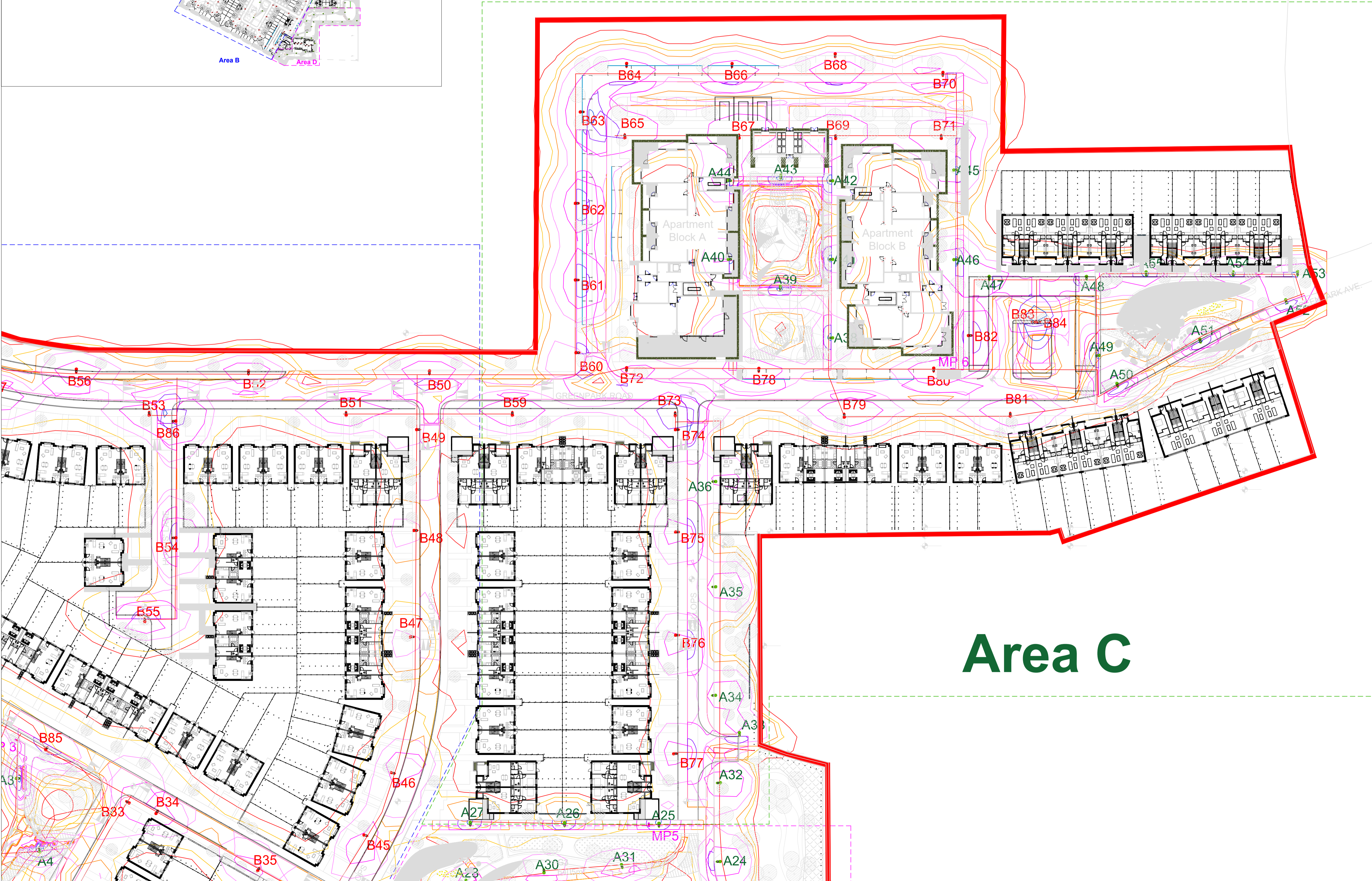

**SITE SPECIFIC NOTES**

- ALL ELECTRICAL INSTALLATION TO BE IN ACCORDANCE NATIONAL RULES OF ELECTRICAL INSTALLATIONS I.S. 10101 OR THE LATEST AMENDMENT AT THE TIME OF CONSTRUCTION.
- LUMINARIES TO BE FITTED ON 4, 6 & 8 METER OCTAGONAL GALVANIZED STEEL COLUMNS.

P-02 FOR PLANNING	23/09/21	POT	KM
P-01 FOR PLANNING	25/08/21	POT	KM
Rev	Description	Date	Dm   Chk



STATUS: **PLANNING**

CLIENT: VOYAGE PROPERTY LIMITED

PROJECT: GREENPARK, DOCK RD, LIMERICK

DRAWING TITLE: PUBLIC LIGHTING LUX LEVELS AREA C

SCALE (@ A1)	DRAWING NUMBER	Revision:
1-500	114-1000- GP - E102	P-02